



INOFLEX metallslang i rostfritt stål, muttrar i mässing kopplingar i rostfritt stål

- Kopplingar**
- fast utv x inv, löpande mutter
 - inv x inv, löpande mutter
 - fast utv förminskad x inv löpande mutter

DN	Koppl. ansl.	L DN	Art.nr. utv x inv	Art.nr. inv x inv
10	3/8 "	75/130 mm	EF501003	EF501013
10	3/8 "	110/210 mm	EF501004	EF501014
10	3/8 "	200/410 mm	EF501006	EF501016
10	3/8 "	260/520 mm	EF501007	EF501017
15	1/2"	75/130 mm	EF501503	EF501513
15	1/2"	110/210 mm	EF501504	EF501514
15	1/2"	200/410 mm	EF501506	EF501516
15	1/2"	260/520 mm	EF501507	EF501517
20	3/4"	75/130 mm	EF502003	EF502013
20	3/4"	110/210 mm	EF502004	EF502014
20	3/4"	200/410 mm	EF502006	EF502016
20	3/4"	260/520 mm	EF502007	EF502017
25	1"	75/130 mm	EF502503	EF502513
25	1"	110/210 mm	EF502504	EF502514
25	1"	200/410 mm	EF502506	EF502516
25	1"	260/520 mm	EF502507	EF502517
32	1" 1/4	75/130 mm	EF503203	EF503213
32	1" 1/4	110/210 mm	EF503204	EF503214
32	1" 1/4	200/410 mm	EF503206	EF503216
32	1" 1/4	260/520 mm	EF503207	EF503217
40	1" 1/2	110/210 mm	EF504004	EF504014
40	1" 1/2	200/410 mm	EF504006	EF504016
40	1" 1/2	260/520 mm	EF504007	EF504017
50	2 "	110/210 mm	EF505004	EF505014
50	2 "	200/410 mm	EF505006	EF505016
50	2 "	260/520 mm	EF505007	EF505017

DN	Koppl. ansl.	L DN	Art.nr. utv x inv
15	1/2" - 3/4"	75/130 mm	EF509903
15	1/2" - 3/4"	110/210 mm	EF509904
15	1/2" - 3/4"	200/410 mm	EF509906
15	1/2" - 3/4"	260/520 mm	EF509907

Maximum arbetstryck vid 20°C

	DN10(3/8")	DN15(1/2")	DN20(3/4")	DN25(1")	DN32(1"-1/4)	DN 40(1"-1/2)	DN 50(2")
Min längd (indragen)	8	7	5	4	3,5	3	2,5
Max längd (utdragen)	12	10	5,5	5,5	5,5	5,5	3,5

Böjningsradie min (mm)

DN10(3/8")	DN15(1/2")	DN20(3/4")	DN25(1")	DN32(1"-1/4)	DN 40(1"-1/2)	DN 50(2")
23	30	40	45	57	69	90

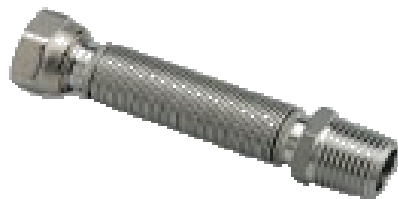

**INOFLEX metallslang i rostfritt stål,
kopplingar i rostfritt stål**

- Kopplingar**
- fast utv x inv, löpande mutter
 - inv x inv, löpande mutter
 - fast utv förminskad x inv löpande mutter

DN	Koppl. ansl.	L DN	Art.nr. utv x inv	Art.nr. inv x inv
15	1/2"	75/130 mm	EF591503	EF591513
15	1/2"	110/210 mm	EF591504	EF591514
15	1/2"	200/410 mm	EF591506	EF591516
15	1/2"	260/520 mm	EF591507	EF591517
20	3/4"	75/130 mm	EF592003	EF592013
20	3/4"	110/210 mm	EF592004	EF592014
20	3/4"	200/410 mm	EF592006	EF592016
20	3/4"	260/520 mm	EF592007	EF592017
25	1"	75/130 mm	EF592503	EF592513
25	1"	110/210 mm	EF592504	EF592514
25	1"	200/410 mm	EF592506	EF592516
25	1"	260/520 mm	EF592507	EF592517

DN	Koppl. ansl.	L DN	Art.nr. utv x inv	Art.nr. inv x inv
15	1/2"	500/1000 mm	EF611500	EF611510
15	1/2"	750/1500 mm	EF611501	EF611511
15	1/2"	1000/2000 mm	EF611502	EF611512
20	3/4"	500/1000 mm	EF612000	EF612010
20	3/4"	750/1500 mm	EF612001	EF612011
20	3/4"	1000/2000 mm	EF612002	EF612012
25	1"	500/1000 mm	EF612500	EF612510
25	1"	750/1500 mm	EF612501	EF612511
25	1"	1000/2000 mm	EF612502	EF612512

DN	Koppl. ansl.	L DN	Art.nr. utv x inv
15	1/2" - 3/4"	75/130 mm	EF599903
15	1/2" - 3/4"	110/210 mm	EF599904
15	1/2" - 3/4"	200/410 mm	EF599906
15	1/2" - 3/4"	260/520 mm	EF599907

Maximum arbetstryck vid 20°C

	DN 15 (1/2")	DN 20(3/4")	DN 25(1")
Min längd (indragen)	7	5	4
Max längd (utdragen)	10	5,5	5,5

Böjningsradie min (mm)

DN 15(1/2")	DN 20(3/4")	DN 25(1")
7	5	4